



Configuring Android for Tango Tango GPS Services

For Android 6.0 and up

Go to menu: **Settings** → **General** → **Location**

- Tap the toggle switch at the top to activate GPS for the phone

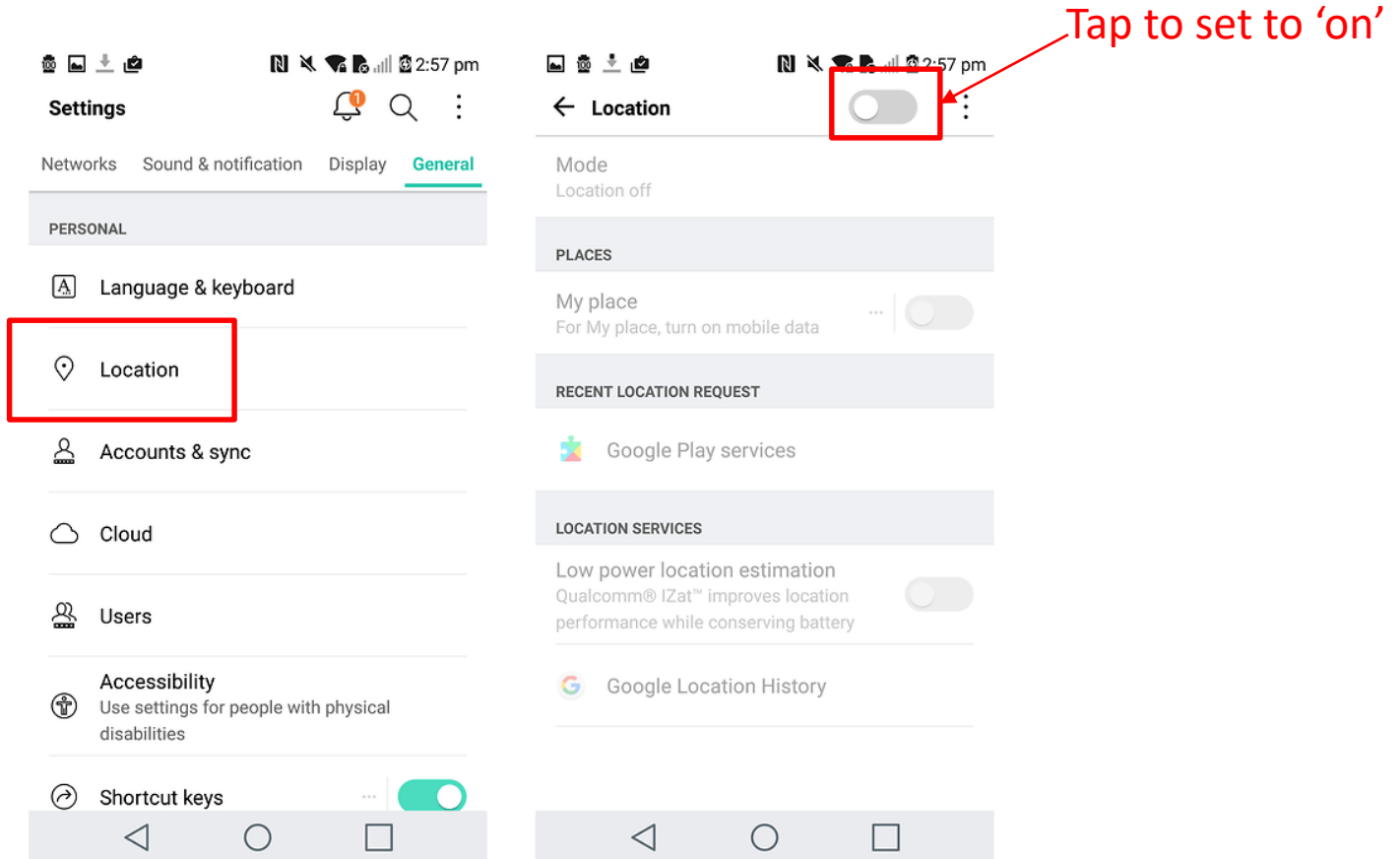

Set 'Mode' option to 'High Accuracy'

- **High accuracy** uses all of the options: GPS, Wi-Fi, Bluetooth and mobile networks.

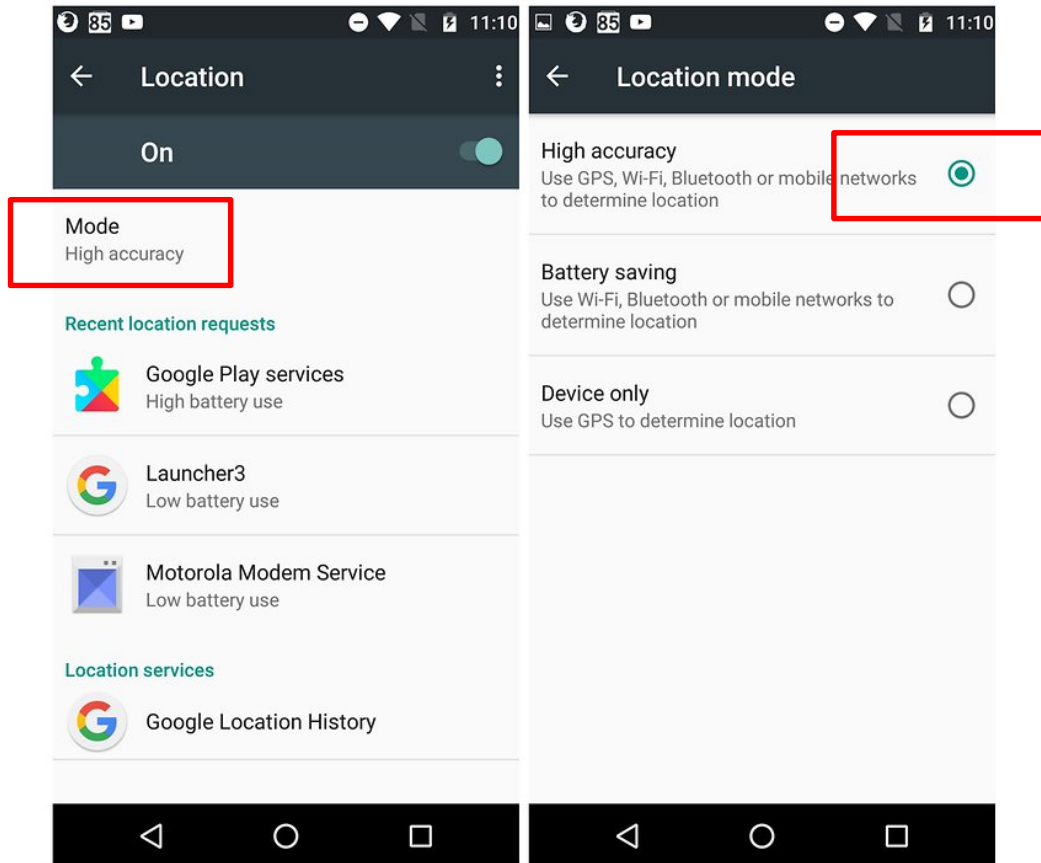

Go to menu: **Settings** → **Apps** → **Configure Apps** → **App Permissions**

- Enable location permission specifically for the Tango Tango app

